

Cat. No. MC2-60C2

# LED 2 Line Message Centers

*Up to 120 Characters*

## MC2 Series

### FEATURES

- > Stores up to 81 messages
- > 100,000 Hr. Multi-color LED Lamp Technology
- > Five message speed settings
- > 26 message operation modes
- > Built-in animations
- > 1 month typical memory retention
- > Built in real-time clock, 12 or 24 hour format
- > Built in serial computer interface- RS232 and RS485
- > Addressable
- > Password protected
- > Power cord with 3 prong plug
- > Continuous message entry with automatic centering in any mode

### AGENCY APPROVALS

- > ETL Listed to ANSI/UL 1950 Second Edition (US)
- > Can/CSA-22.2 No. 950-M89 (Can)
- > FCC Part 15 Class A

[www.leedan.com](http://www.leedan.com) [info@leedan.com](mailto:info@leedan.com) Toll-Free: 800-231-1414

The Edwards MC2 Series of Message Centers are indoor rated multi-color LED communication centers. They may be used as a single stand-alone message center or can be networked into a company wide communication system. When networked, one message can be transmitted from the controlling computer software to the serial computer interface on all the message centers within the facility or discrete messages can be sent to specific addresses within the communication network of messages centers.

The units may be wall or ceiling mounted using the supplied hardware. Designed for commercial and industrial indoor communication, Edwards Message Centers can display production goals and performance, safety goals and performance, changes in employee benefits, company announcements and achievements as well as boost morale through employee recognition. May be used in commercial establishments from stores to restaurants to assist with internal and external communications.

#### Hand Held Remote Programmer

A 54 key hand held remote control keyboard with easy to understand programming instructions is supplied with each Edwards Message Center. MC-RP (supplied with each unit). Batteries included.

#### Accessories

Infrared Message Loader with 3 foot cable and 9V battery — MC-RIRL

Ceiling or wall mount bracket — MC4-CWMK

Double sided hanging bracket — MCDSHB

Three sided mounting bracket — MC3SMK

# TECHNICAL INFORMATION

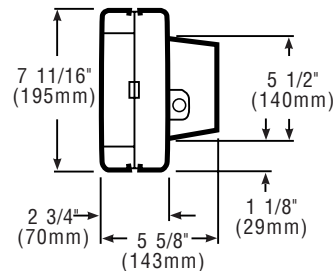
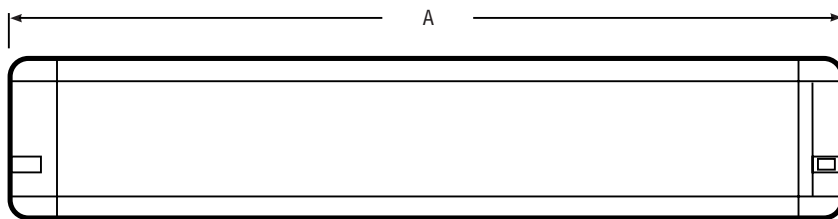

Cat. No.	MC2-60(C or R)2	MC2-80(C or R)2	MC2-100(C or R)2	MC2-120(C or R)2
<b>A Dimension</b>	40 1/8" (1019mm)	52 1/8" (1324mm)	64 1/8" (1629mm)	76 1/8" (1934mm)

Cat. No.	Power	No. characters min/typ/max	Character size Array	Pixel size diameter x center to center spacing	Pixel Color	Weight	Max. viewing distance w/ largest font*	Message capacity	Operating environment	Case dimen./display Dimen.
MC2-60C2	120V AC ± 10% 120 watt max.	One line 10/12/15 Two line 40/40/60	One line 4.8" Two line 2.1"  Array 120 x 16 pixels	.2" x .3"	Each pixel can be red, green or amber	18.5 lbs.	200 ft	81 different messages can be stored & displayed 28,000 characters	32-120°F 0-95% relative humidity non-condensing	40.1" L 5.5" D 7.7" H/ 4.8" H 36" L
MC2-60R2					Red					
MC2-80C2	120V AC ± 10% 120 watt max.	One line 14/16/20 Two line 52/52/80	One line 4.8" Two line 2.1"  Array 160 x 16 pixels	.2" x .3"	Each pixel can be red, green or amber	24.5 lbs.	200 ft	81 different messages can be stored & displayed 28,000 characters	32-120°F 0-95% relative humidity non-condensing	52.1" L 5.5" D 7.7" H/ 4.8" H 48" L
MC2-80R2					Red					
MC2-100C2	120V AC ± 10% 120 watt max.	One line 18/20/25 Two line 66/66/100	One line 4.8" Two line 2.1"  Array 200 x 16 pixels	.2" x .3"	Each pixel can be red, green or amber	31 lbs.	200 ft	81 different messages can be stored & displayed 28,000 characters	32-120°F 0-95% relative humidity non-condensing	64.1" L 5.5" D 7.7" H/ 4.8" H 60" L
MC2-100R2					Red					
MC2-120C2	120V AC ± 10% 180 watt max.	One line 20/24/30 Two line 80/80/120	One line 4.8" Two line 2.1"  Array 240 x 16 pixels	.2" x .3"	Each pixel can be red, green or amber	37.5 lbs.	200 ft	81 different messages can be stored & displayed 28,000 characters	32-120°F 0-95% relative humidity non-condensing	76.1" L 5.5" D 7.7" H/ 4.8" H 72" L
MC2-120R2					Red					

[www.leedan.com](http://www.leedan.com) [info@leedan.com](mailto:info@leedan.com) Toll-Free: 800-231-1414